



jordanfishwick

Heatherfield Court

£750 PCM



Heatherfield Court, Cheshire, SK9 2QE

£750 PCM

This immaculate ground floor studio apartment is located at the top of this quiet cul de sac on this popular estate within walking distance of Wilmslow town centre and the train station but with excellent access to the A34, Manchester International Airport and the motorway networks .

This apartment is FURNISHED and is AVAILABLE END OF FEBRUARY also benefits from off road parking

Communal entrance, private entrance hall lounge diner, fully fitted kitchen with built in electric hob and gas oven, washer/dryer and fridge, separate double bedroom, bathroom with shower. Communal gardens and parking area. GAS CENTRAL HEATING. FULLY DOUBLE GLAZED

VIEWING ESSENTIAL

Contact Wilmslow 01625 536 300 £750.00pcm

COUNCIL TAX A

EPC C

LOCATION

Jordan Fishwick Estate and Letting Agents Wilmslow office is located in a prime position central to the bustling and stylish town centre. With our impressive frontage it's impossible to miss our attractive office. Managed by Guy Grainger, Partner, who has been an Estate Agent since 1980, and has a wealth of local knowledge and experience With busy sales and lettings departments all under the same roof along with our independent mortgage advisor on hand the Wilmslow branch has everything you need to help with your sales or lettings transactions. Knowledgeable and friendly staff also compliment the range of services we offer and we are known throughout the Wilmslow area for our proactive approach in helping people find their dream home

DIRECTIONS

From our Wilmslow office proceed north on Alderley road until you reach the traffic lights , take a right onto Manchester Road when you reach the roundabout take the third exit onto Bollin Valley Link and at the next roundabout take the first exit onto the A34 , proceed until the next round about and take the first exit onto Dean row at the next roundabout take the fourth exit onto Dean Row Road , proceed to the next set of traffic lights where you will be taking the right turn onto Pinewood Road then the second left onto Fieldhead Road, follow the road round and Heatherfield Court is at the end of the road

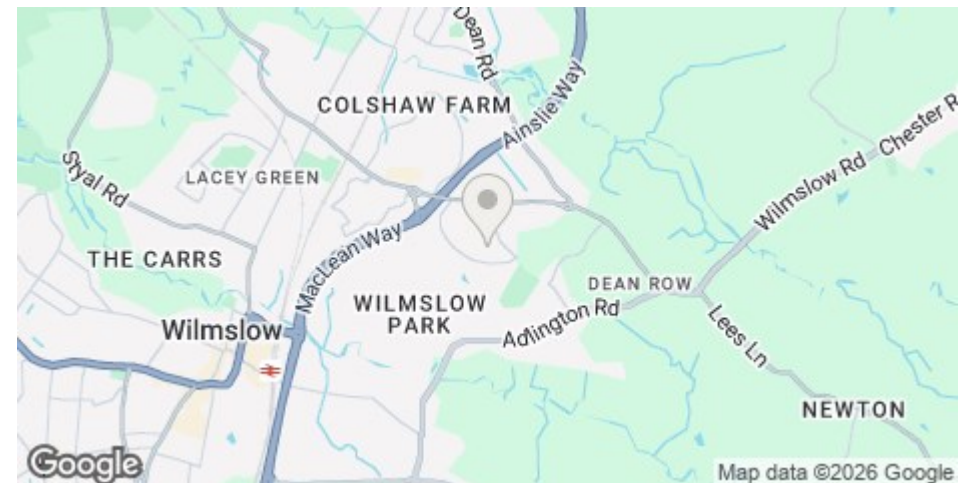

- GROUND FLOOR APARTMENT
- FURNISHED
- EXTREMELY POPULAR LOCATION
- OFF ROAD PARKING
- COUNCIL TAX A
- EPC C

Postcode - SK9 2QE

EPC Rating - C

Floor Area - sq ft

Local Authority - Cheshire East Council

Council Tax - A

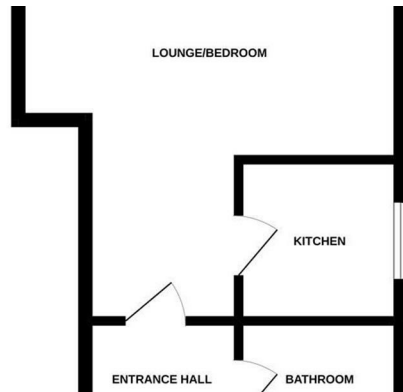

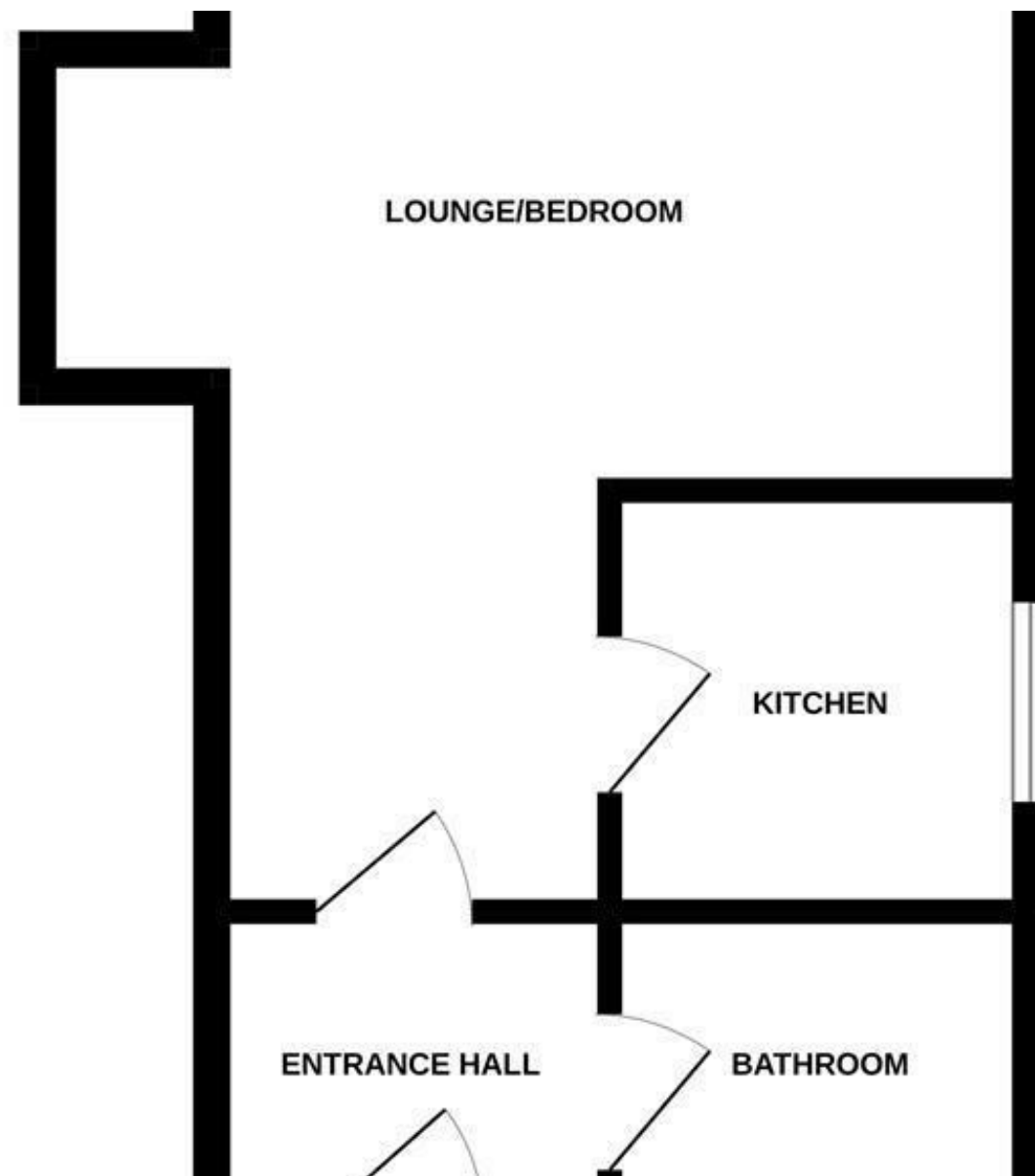

These particulars are believed to be accurate but they are not guaranteed and do not form a contract. Neither Jordan Fishwick nor the vendor or lessor accept any responsibility in respect of these particulars, which are not intended to be statements or representations of fact and any intending purchaser or lessee must satisfy himself by inspection or otherwise as to the correctness of each of the statements contained in these particulars. Any floorplans on this brochure are for illustrative purposes only and are not necessarily to scale.

Offices at: Offices at Chorlton, Didsbury, Disley, Hale, Glossop, Macclesfield, Manchester Deansgate, Manchester Whitworth Street, New Mills, Sale, Wilmslow and Withington

01625 536300